

1400
CALIFORNIA
SAN FRANCISCO, CALIFORNIA

HALEY KLEIN
office 415.404.7330
haley@mavenproperties.com
DRE #01907308



FEATURES

- +/- 1,717 SF
- Prime hard corner location
- Expansive windows and natural lighting
- Existing Type 1 hood and restaurant FF&E
- Excellent proximity to Trader Joe's/CVS center as well as Polk Street businesses
- Located in nostalgic Russian Hill neighborhood near iconic cable car line
- Neighbors Trader Joe's, CVS, Liquid Gold, & Nourish Cafe

HYDE STREET

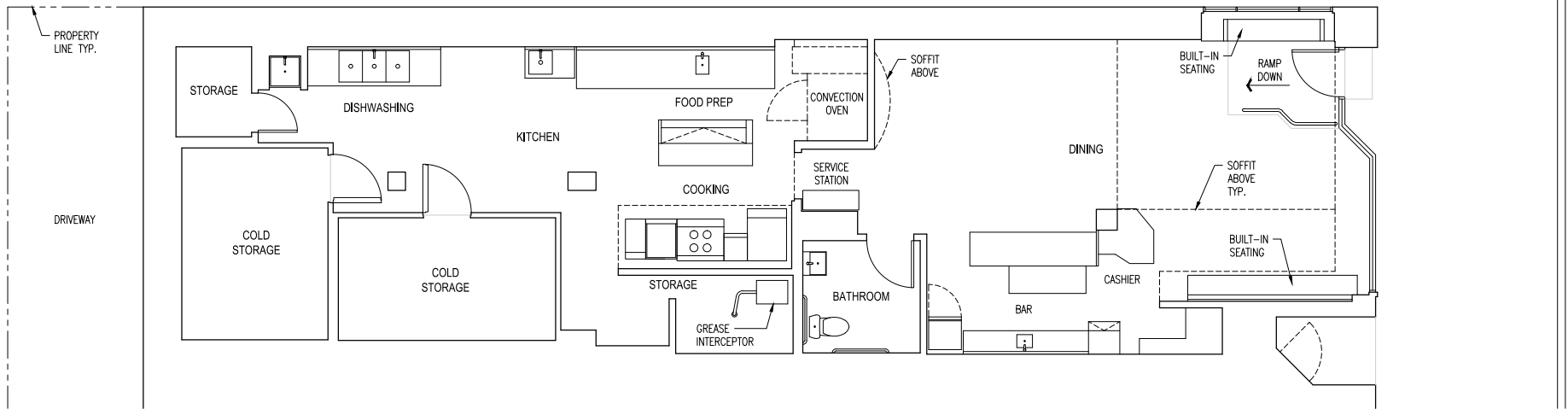

CALIFORNIA STREET

LEVEL 1



PEOPLES BARBER



DUNYA MEDITERRANEAN BISTRO



WHOLE FOODS



CONTRABAND COFFEE



ACQUERELLO



HOUSE OF PRIME RIB



CRUSTACEAN



TRADER JOE'S



WALGREENS

1400 CALIFORNIA



99

WALKABLE CITY HUB

Thriving urban hub provides abundant walkable retail and restaurant amenities.



100

PUBLIC TRANSPORTATION HUB

The Property is located at the junction of major MUNI, and Bus lines.



77

BIKE FRIENDLY NEIGHBORHOOD

Neighborhood amenities such as dedicated bike lanes, and ample bicycle parking.

1400 
CALIFORNIA
SAN FRANCISCO, CALIFORNIA

maven
RETAIL • OFFICE • INDUSTRIAL

HALEY KLEIN
office 415.404.7330
haley@mavenproperties.com
DRE #01907308

NOTICE: This information has been secured from sources we believe to be reliable but we make no representations, warranties, express or implied, as to the accuracy of the information. Listing broker has been given enough information to provide only a preliminary interest in the property. The materials are not to be considered fact. The information contained herein is not a substitute for thorough due diligence investigation. References to square footage, zoning, use, or age are approximate. Please contact the San Francisco Planning Department to verify zoning at (415) 558-6378, as neither broker or landlord represent that this space is suitable for your use. Tenant or Buyer must verify the information at their own expense and bears all the risk for any inaccuracies. By receiving these materials you are agreeing to the disclaimers set forth herein. DRE#01878802

466 Green Street Suite #203 | San Francisco, CA 94133 | 415.781.7700